

PV system monitoring for Fronius **IG Plus** series

Components and configuration options

Configuration options for monitoring the PV system

• Monitoring using Signal Card	1
• Monitoring using Personal Display	2
• Monitoring with Fronius IG DatCom	
• Fronius IG DatCom-components	3
• Basic DatCom system layout	
• Datalogger <i>easy</i> Card	4
• Datalogger <i>profi</i> Card	5
• Datalogger <i>profi</i> Box	6
• Details of terminating plugs	
for Fronius IG DatCom	7

• Additional components	
• Fronius IG Public Display	8
• RiCo Display with Public Display Card	9
• RiCo Display with Public Display Box	10
• Sensors with Sensor Card	11
• Combination of components	
• Public Display + Sensor Box	12
• Public Display + Sensor Box + FRONIUS SolarWeb + Fronius IG. <i>message</i>	13
• String Control (ideal for Fronius IG central inverters)	
• String Control + Basis DatCom	14

Fronius IG Signal Card

System with alarms in the event of malfunction, no PC / 1 inverter

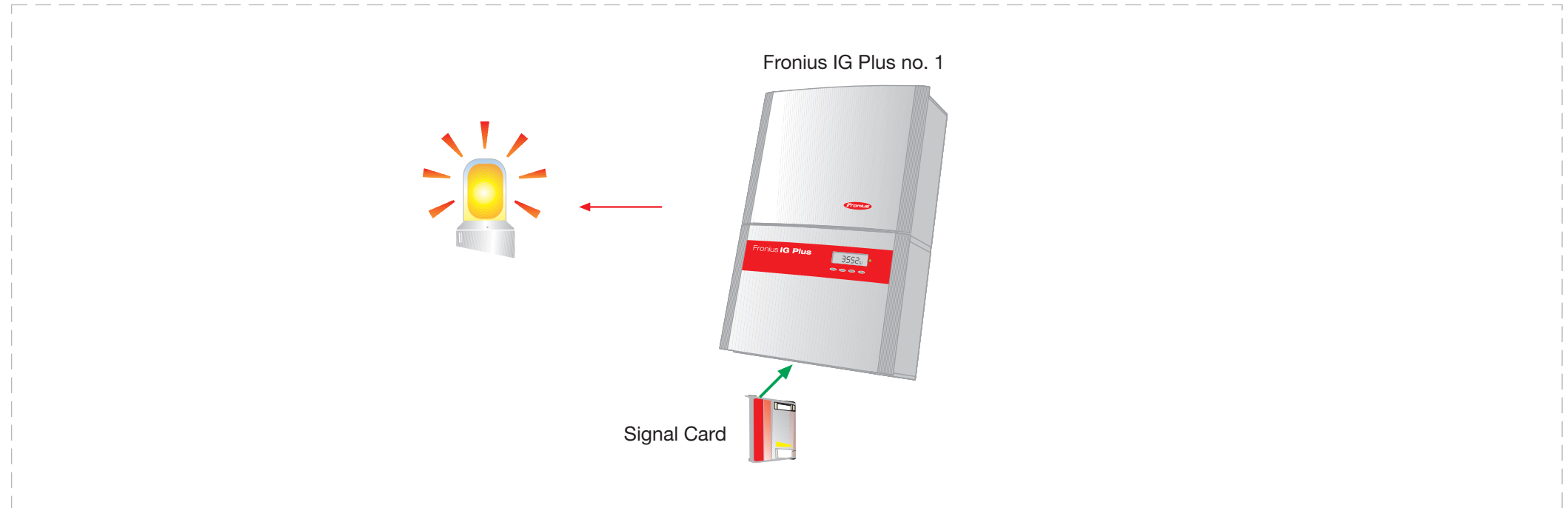

- 1 Signal Card for each inverter
- Several inverters to one signal
- No datalogger or other DatCom components required.

Fronius IG Personal Display

System with remote monitoring (up to 300 m), no PC / several inverters

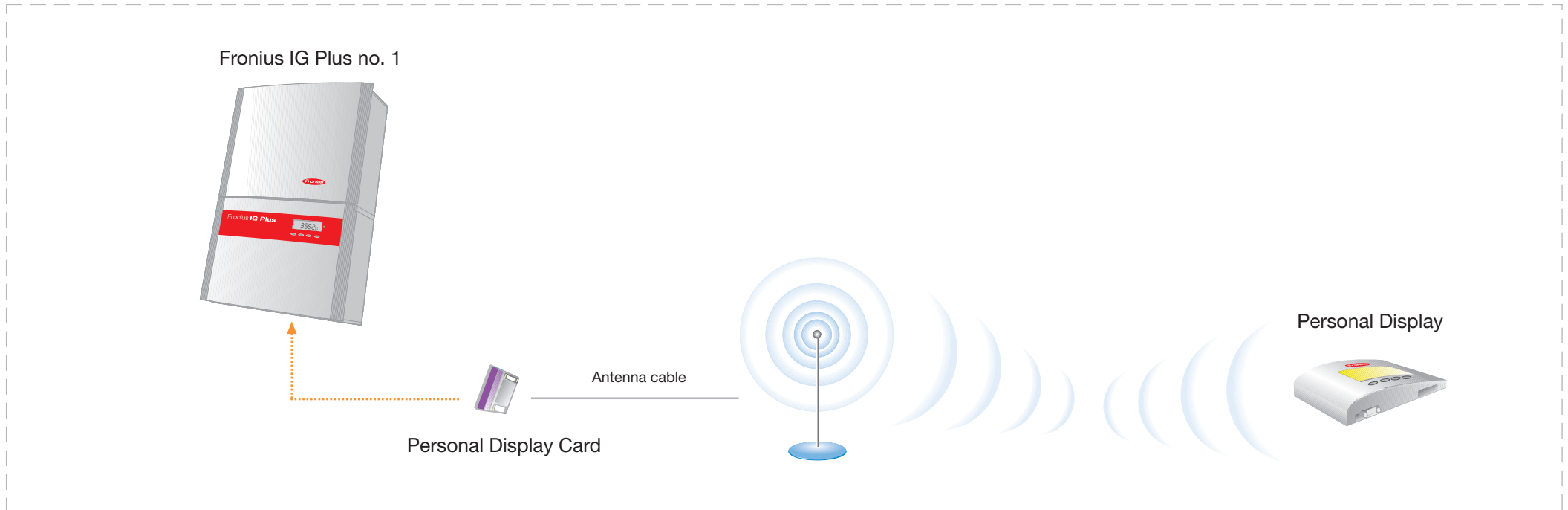

- 1 Personal Display Card and antenna required for each Fronius IG Plus
- Displays data from up to 15 inverters
- No datalogger or other DatCom components required.

Fronius **IG** DatCom components

A DatCom system comprises:

- just one Datalogger Card/Box
and up to
- 100 Fronius IG Plus with COM Cards
- 10 Sensoren Cards/Boxes
- 10 Public Display Cards/Boxes
- 200 String Controls

The following products extend the functionality of your Fronius **IG Plus**, and are not DatCom components:

- Fronius IG Signal Card
- Fronius IG Personal Display

Fronius IG DatCom / Datalogger Easy Card

System monitoring with a PC / 1 inverter

Basic configuration with modem, as recommended by Fronius

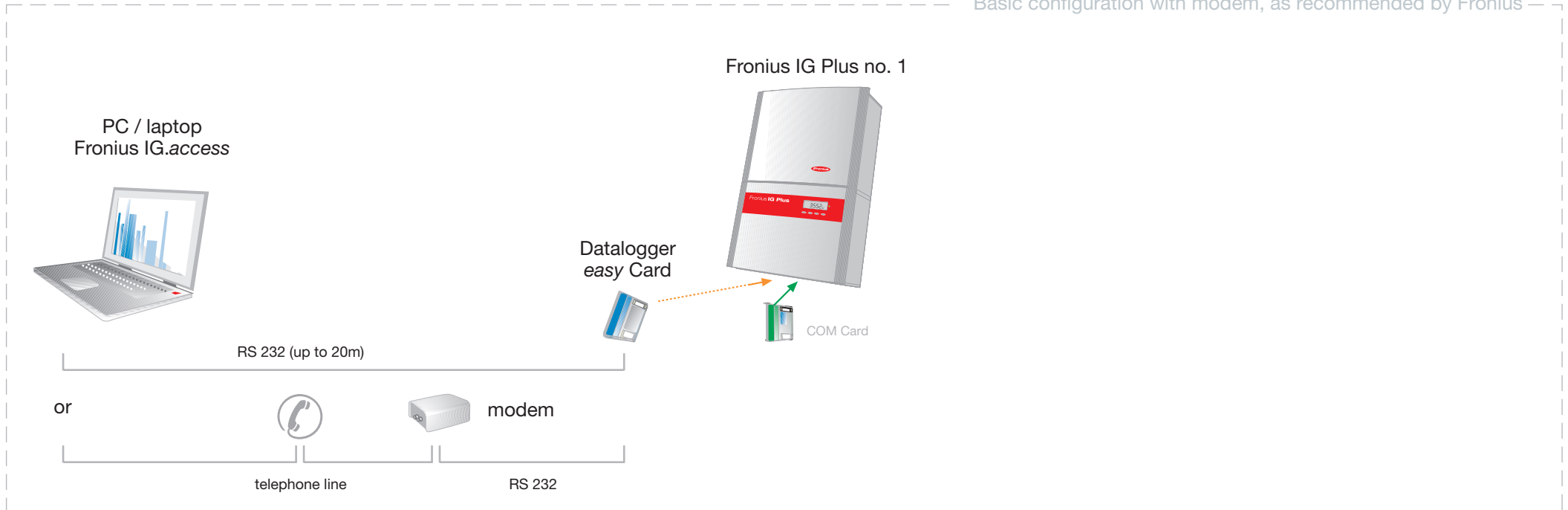

Fronius IG DatCom / Datalogger Profi Card

System monitoring with a PC / several inverters

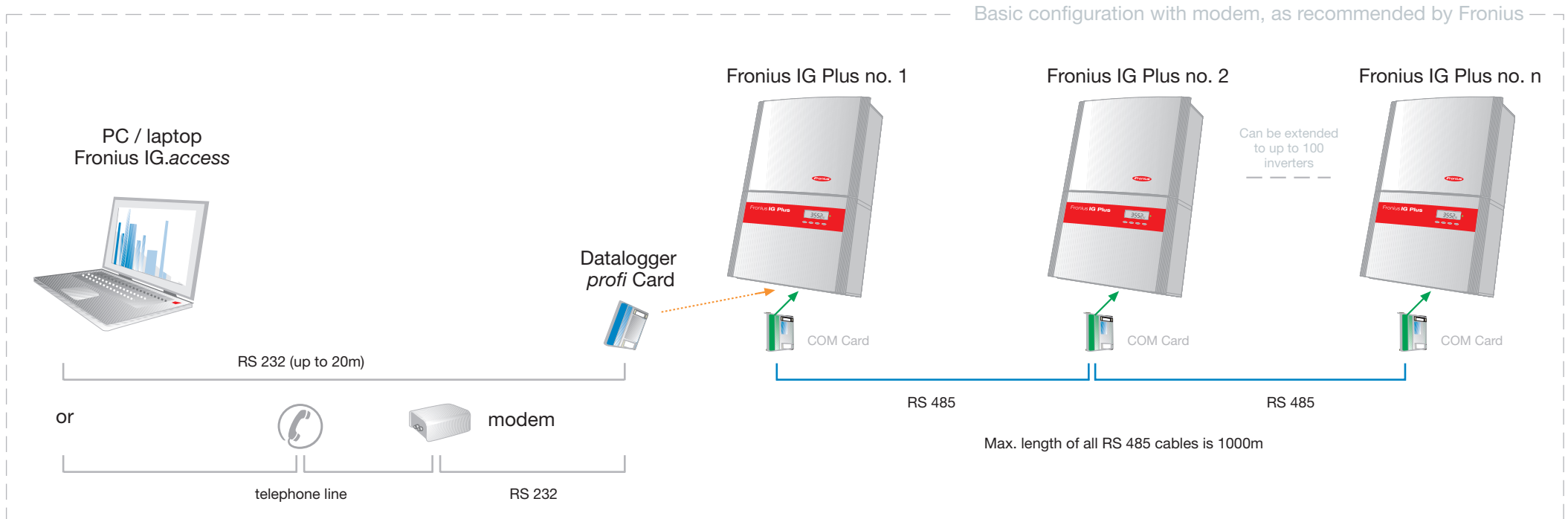

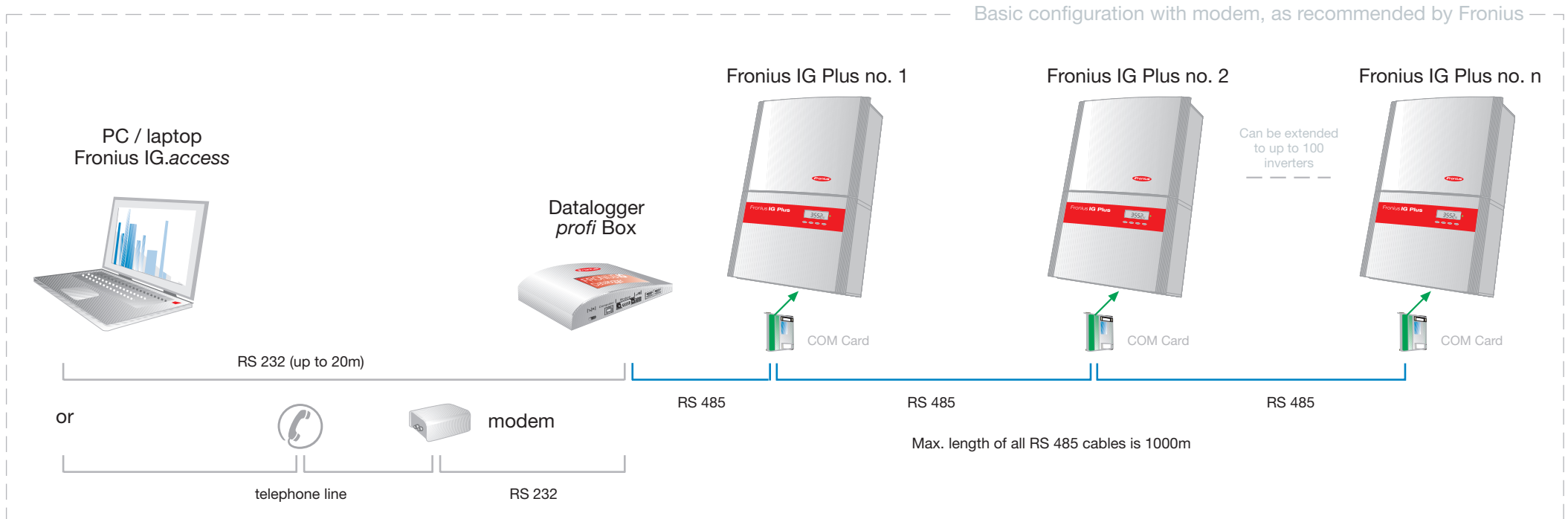

Fronius IG DatCom / Datalogger Profi Box

System monitoring with a PC / several inverters

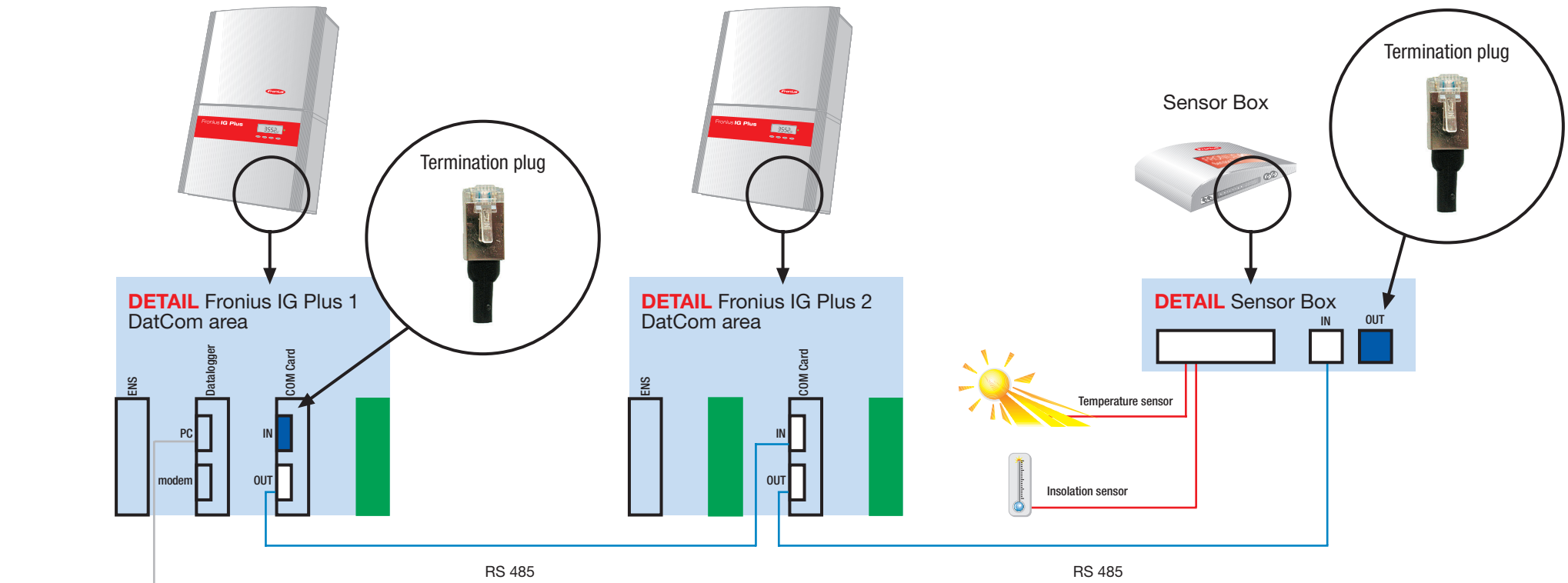

Fronius IG DatCom - details



 Free slot for additional card.

 Termination plug:
The first and last free RJ 45 socket in the system must have a termination plug installed (included with datalogger).

Fronius IG DatCom / Public Display

System monitoring with a PC / several inverters / Public Display

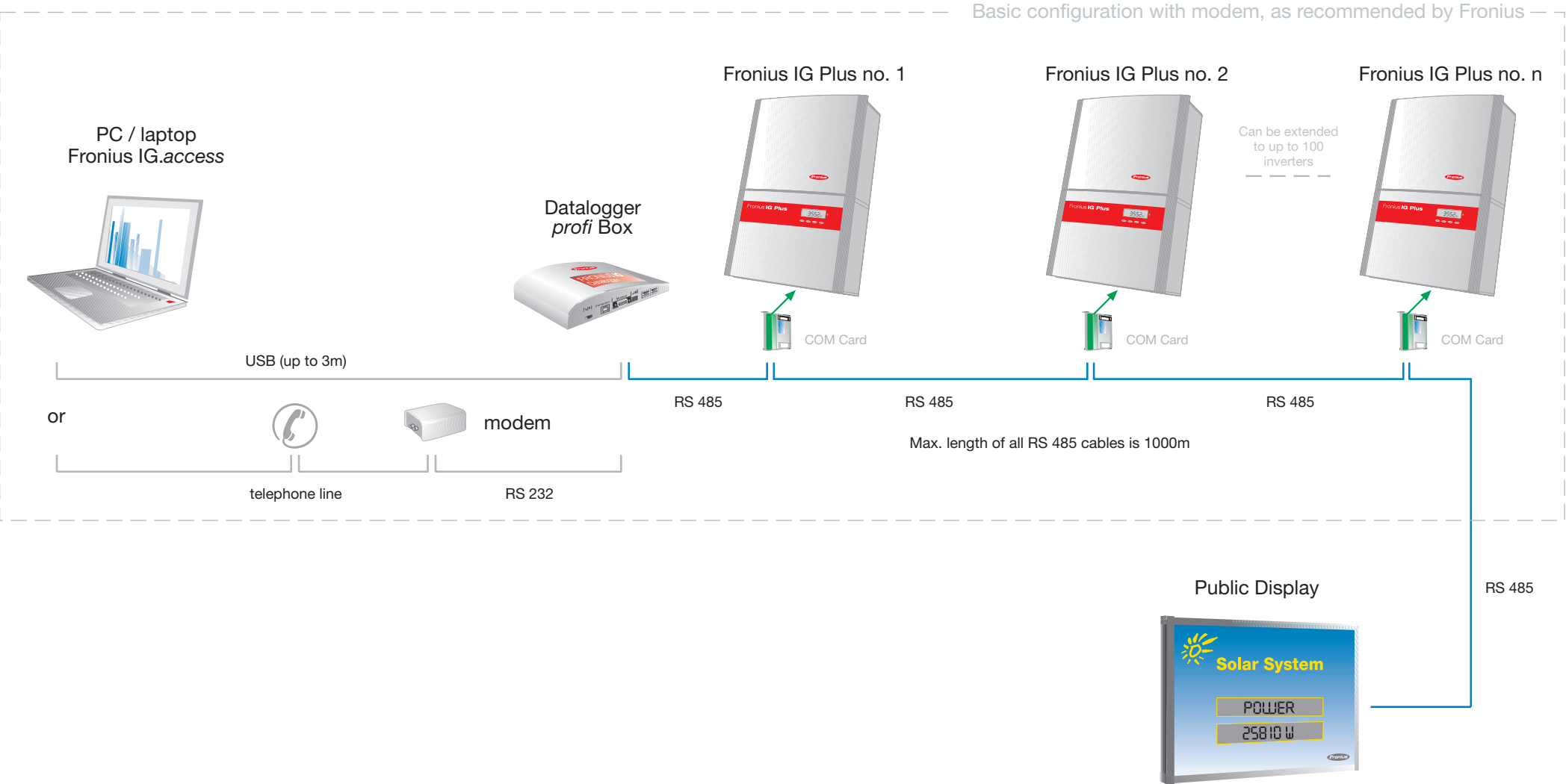

Fronius IG DatCom / Rico Display

System monitoring with a PC / several inverters / Rico Display

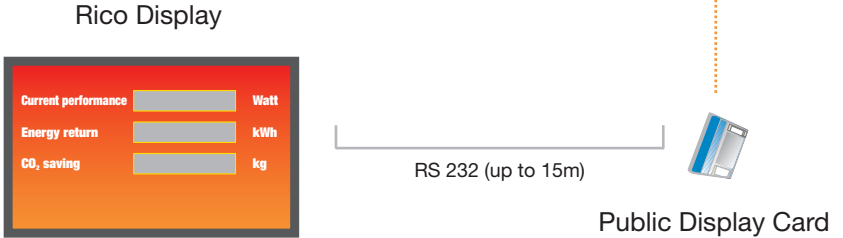
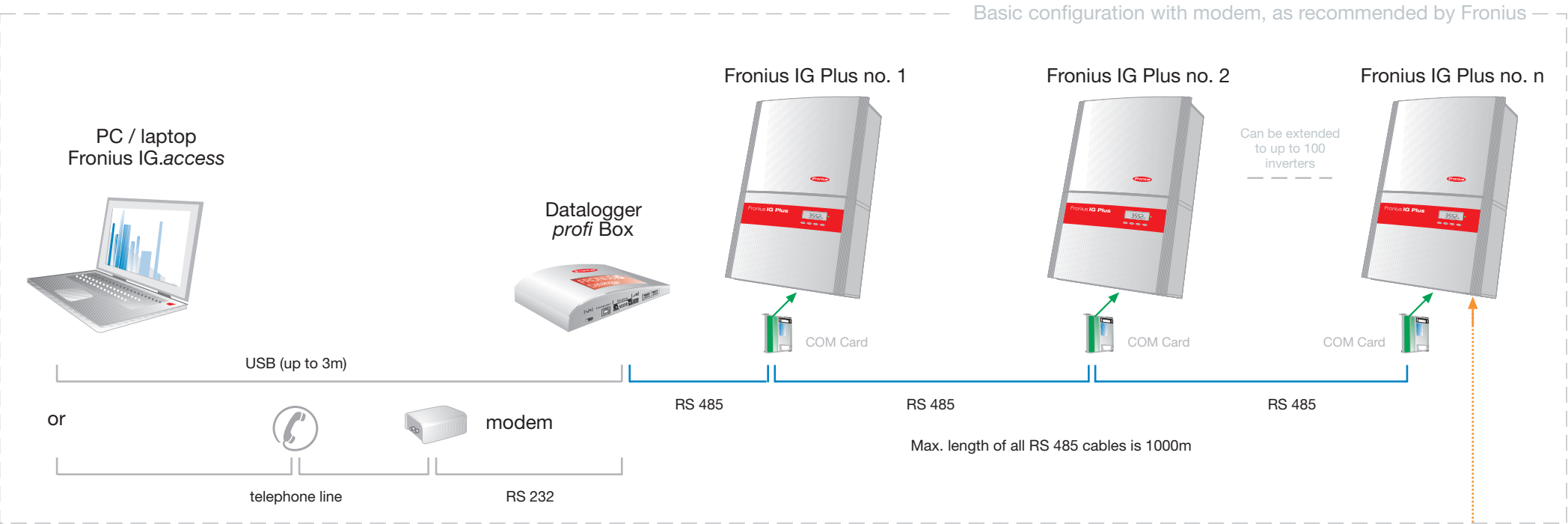

Fronius IG DatCom / Rico Display

System monitoring with a PC / several inverters / Rico Display

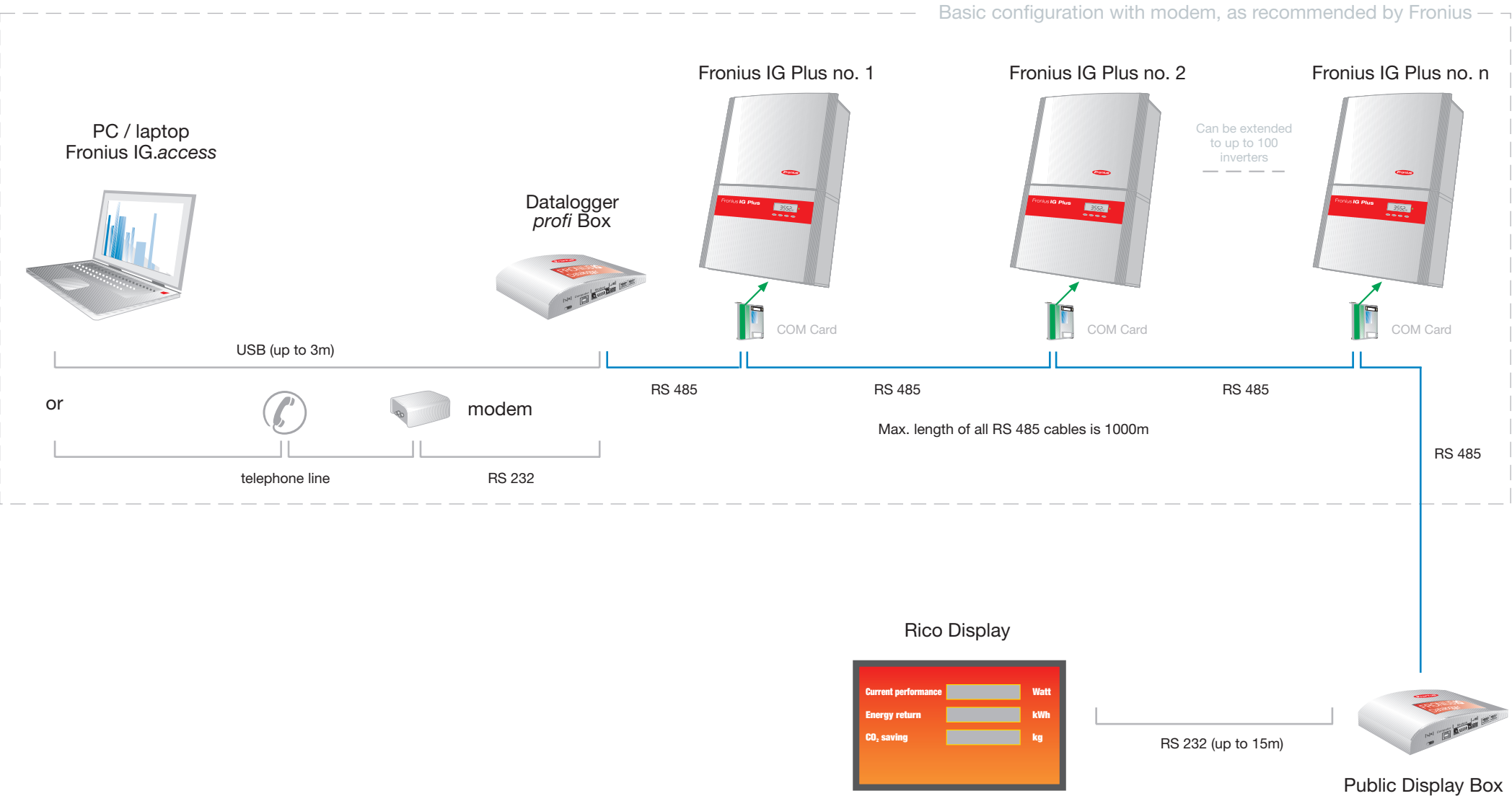

Fronius IG DatCom / Sensor Card

System monitoring with a PC / several inverters / using sensors

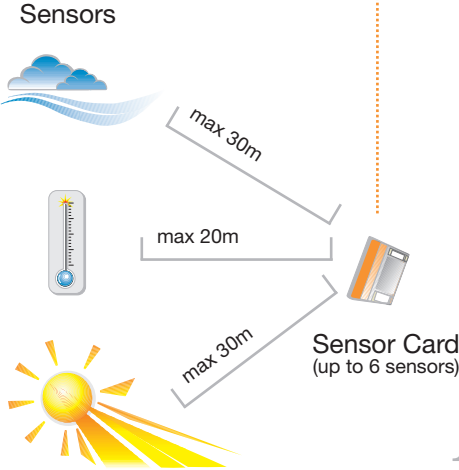
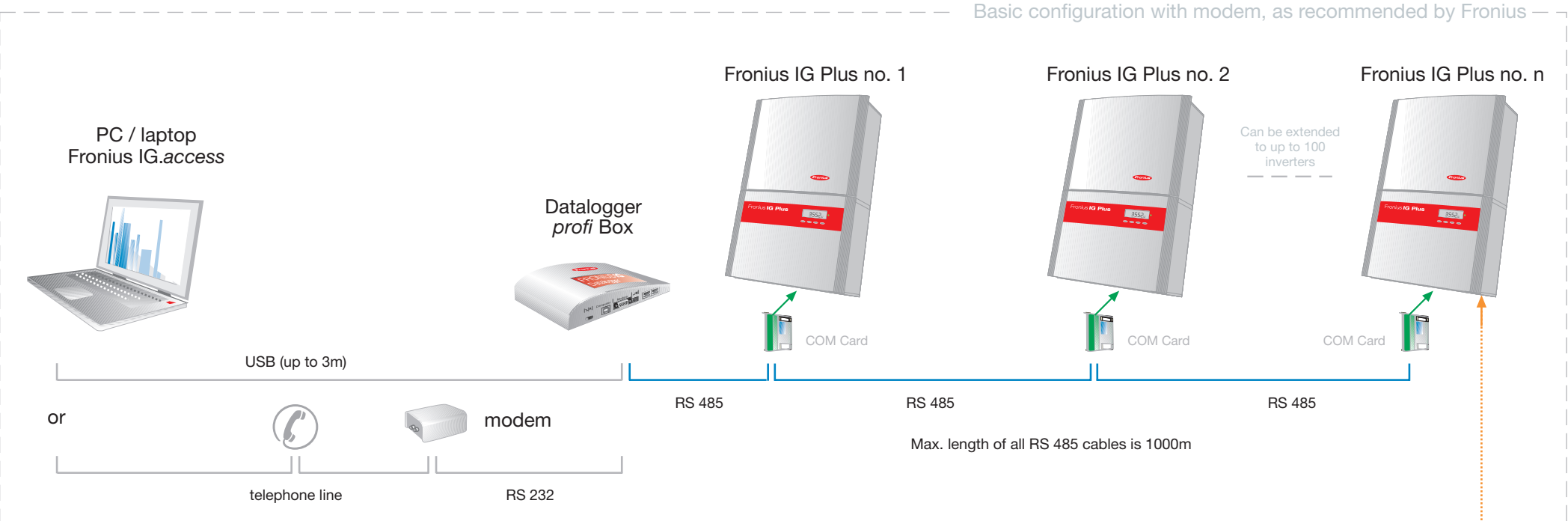

Fronius IG DatCom / Public Display / Sensor Box

System monitoring with a PC / several inverters / using sensors / Public Display

Basic configuration with modem, as recommended by Fronius

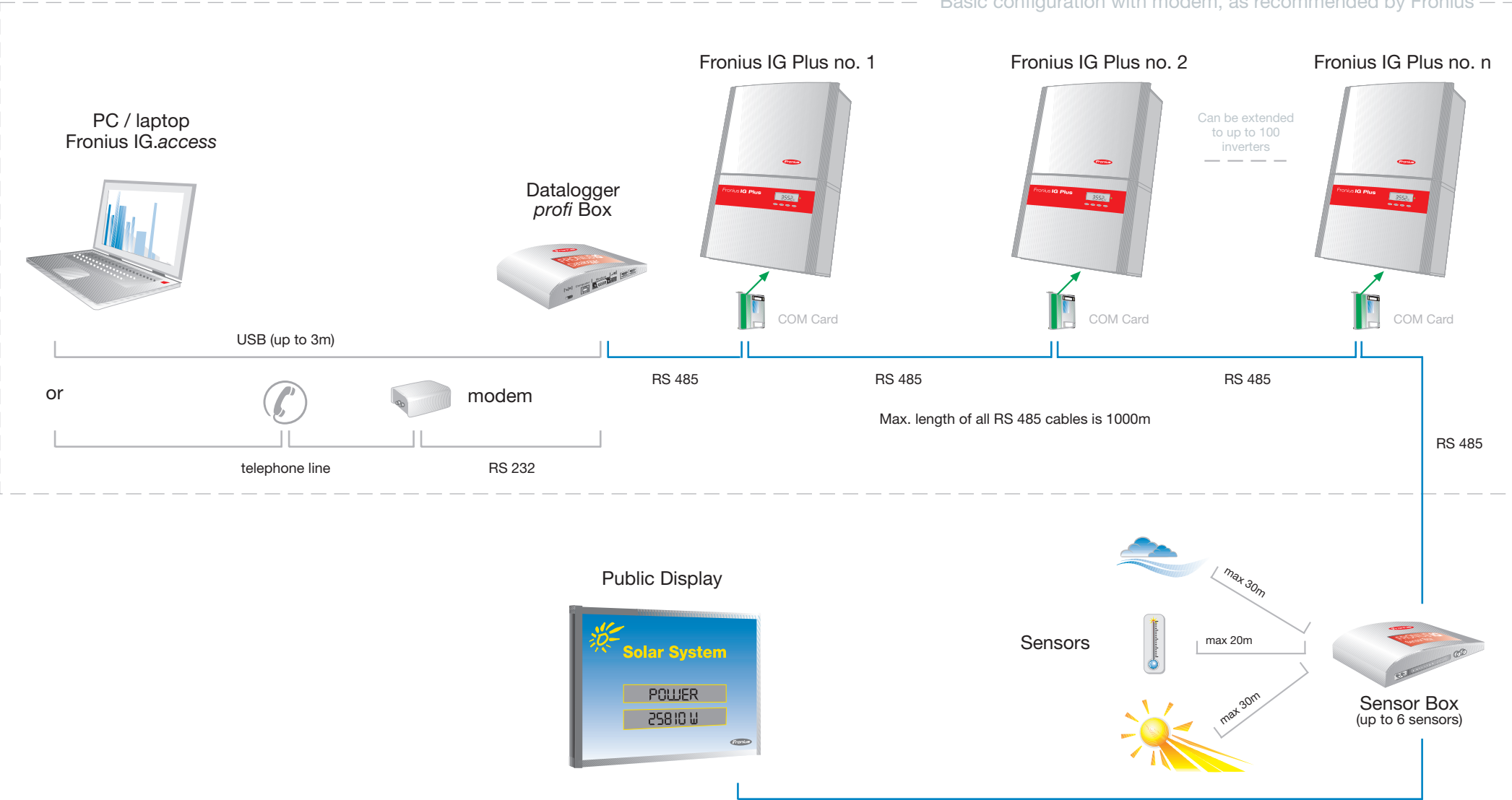

Fronius IG DatCom / Classic

System monitoring with a PC and internet

Basic configuration with modem, as recommended by Fronius

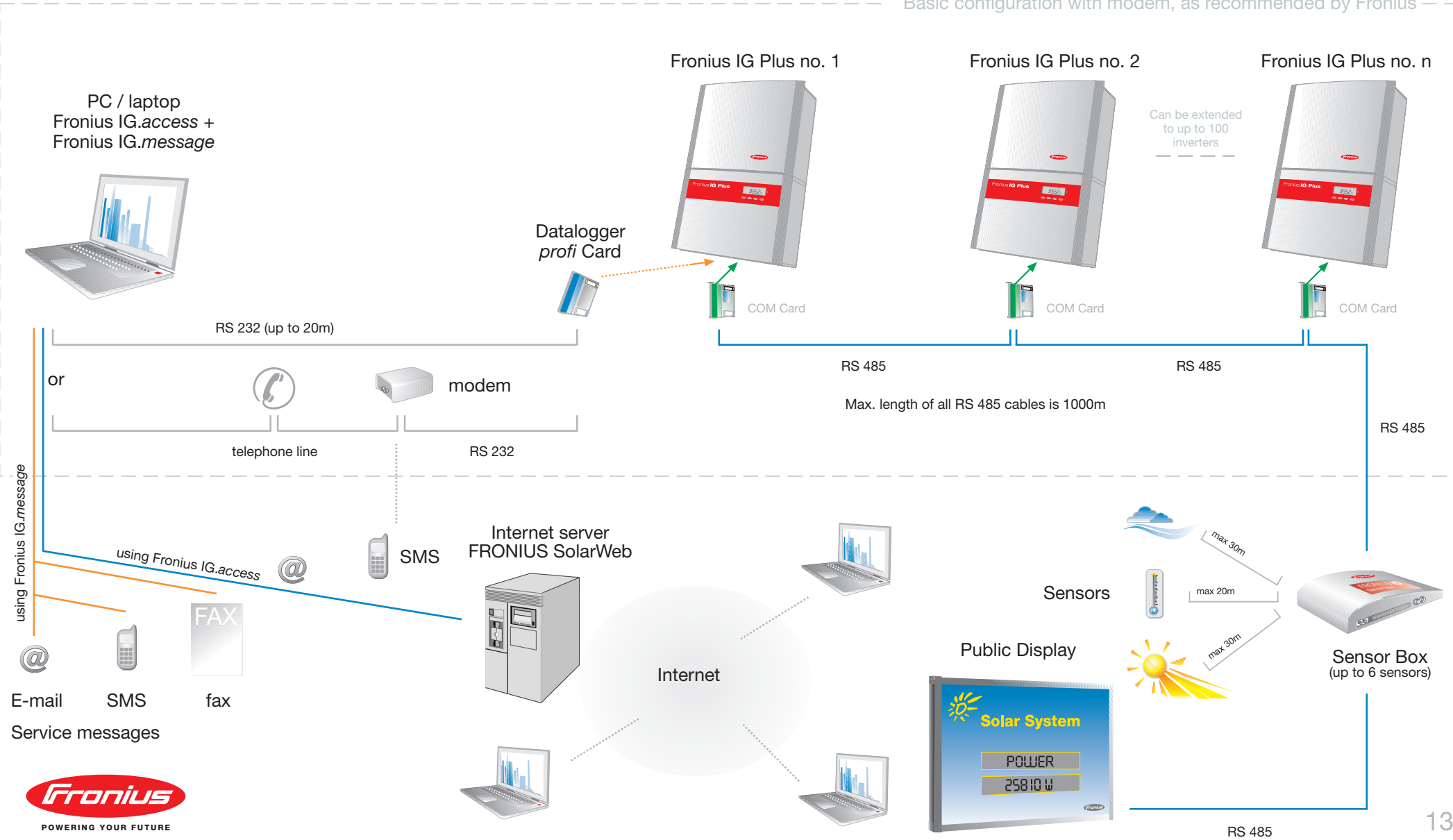

Fronius IG DatCom / String Control

System with Fronius IG central inverter and String Control (optional)

